

Villa application

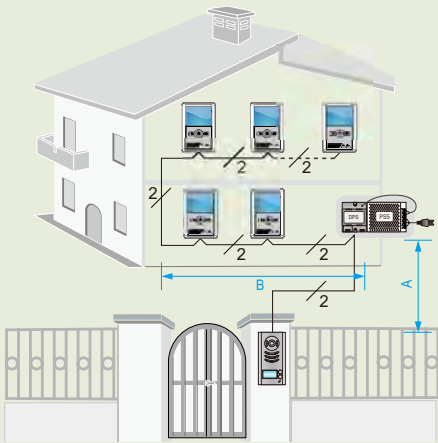

Cable and Distance

Cable	A(m)	B(m) ≤2 VT25	B(m) ≤16 VT25
CAT5 Cable (Combined)	40	80	—
Pair Cable (Parallel) 2X0.75 mm ²	30	50	—
Twisted Cable 2X0.75 mm ²	60	100	40
Twisted Cable 2X1.0 mm ²	80	120	60

Extending Monitors(up to 16)

In-Out topology:

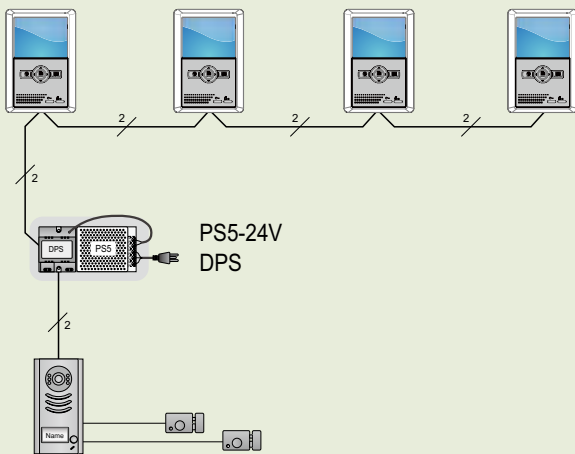

Star topology:

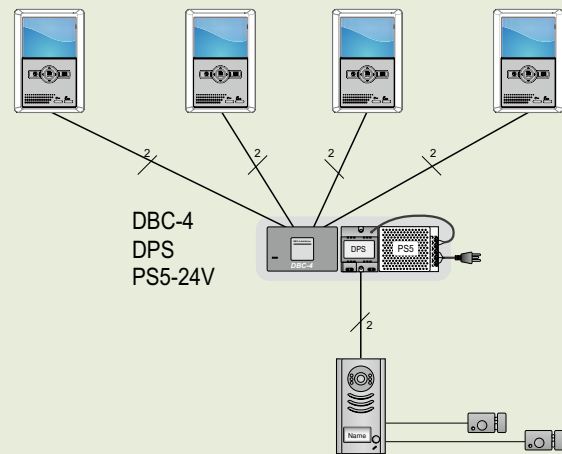

Extending Door/CCTV Cameras

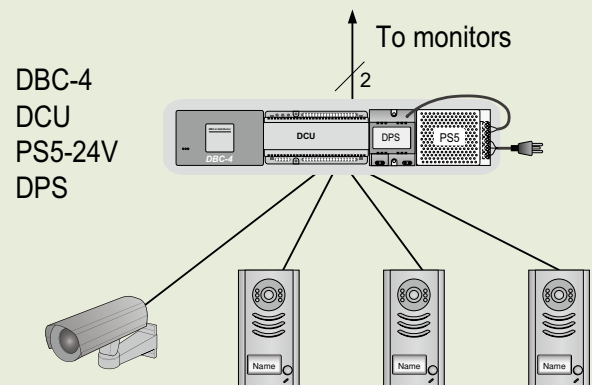
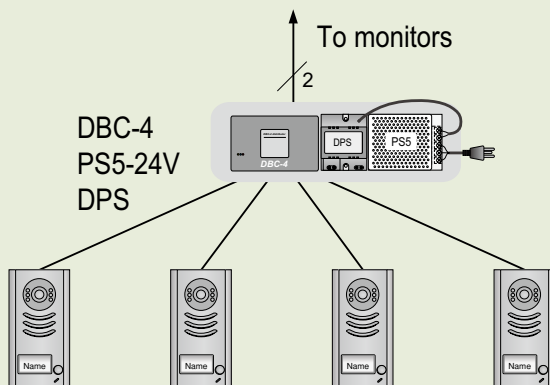

2 -Wire Video System

User Manual

Do please read this manual

Important note: Take extreme care when dismantling the front cover from either door panel as the microphone is attached on a small and fine cable that could break



591

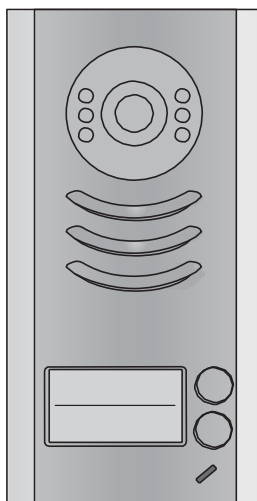

592

1. Parts and Functions

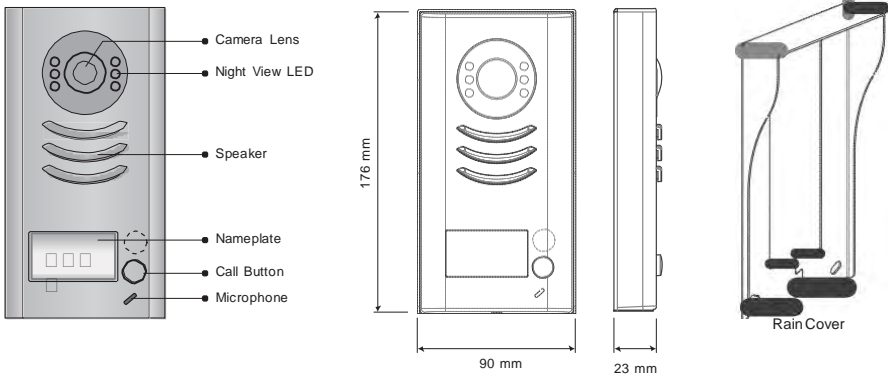

Note: 592 has two call buttons.

2. Terminal Descriptions

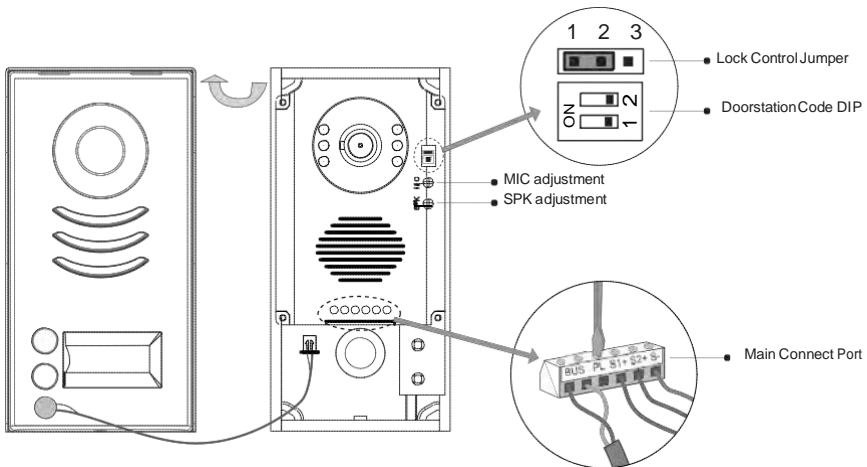

- **Lock Control Jumper:** To select the lock type: see 5.2.1 , 5.2.2
- **Doorstation Code DIP:** Total 4 doorstations can be supported, see 6.1
- **Main Connect Port:** To connect the bus line and the electronic locks.
- **BUS:** Connect to the bus line, no polarity.
- **PL:** External lock power input, connect to the power positive(power +).
- **S1+, S2+:** Lock power(+) output, to connect 2 locks.
- **S-:** Lock power(-) output, connect to the power(-) input of locks(only when using the camera to power the locks, if using the external power supply for the locks, the S- will not be connected).

3.Specifications

Lock Power supply:	12Vdc, 300mA(Internal Power)
Power Consumption:	1W in standby, 12W in working
NO, COM dry contact:	Max. 48V dc 1.5A
Unlocking time:	1 to 9 seconds, set by Monitor
Working temperature:	-10°C ~ 45°C

4.Mounting

4.1 Mounting Without Rain Cover

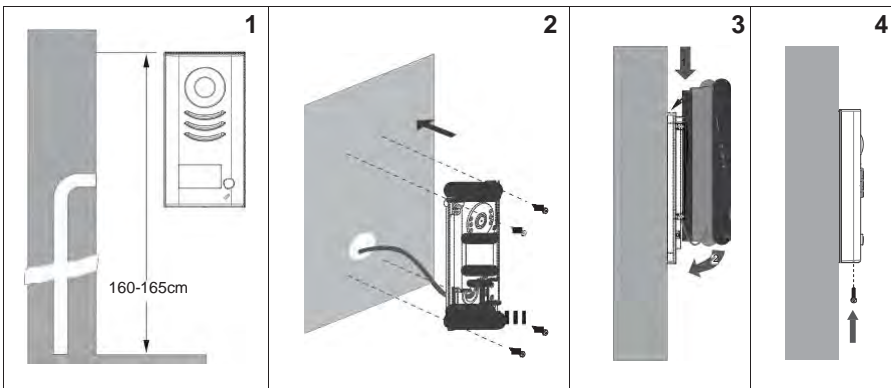

4.2 Mounting With Rain Cover

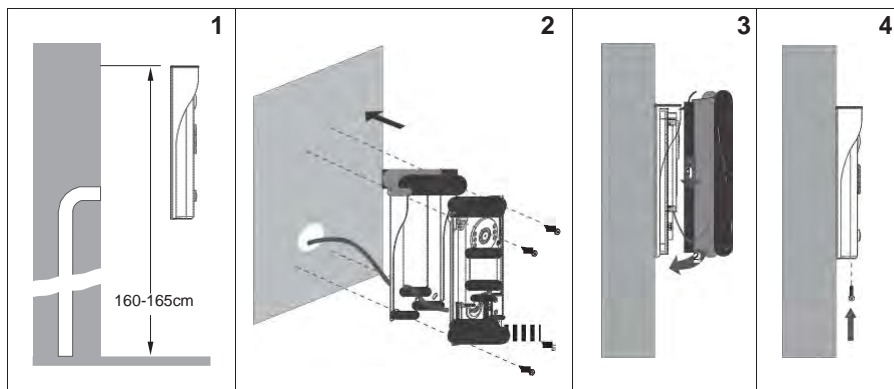

4.3 Placing Name Label

Move the plastic cover away to open the transparent name label cover, insert a name card, then put the plastic cover back to the panel.

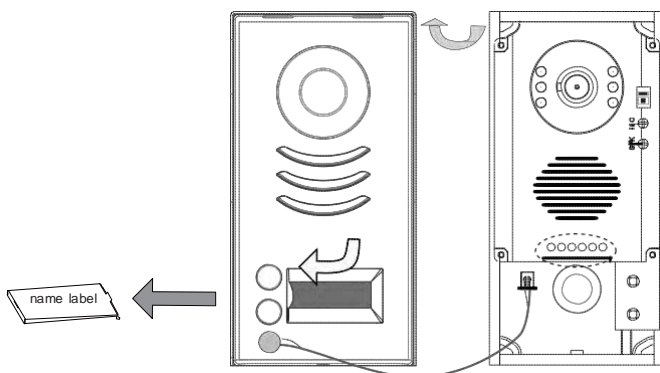

4.4 Adjusting Camera Angle

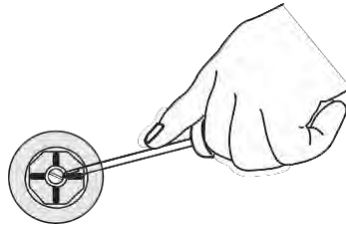
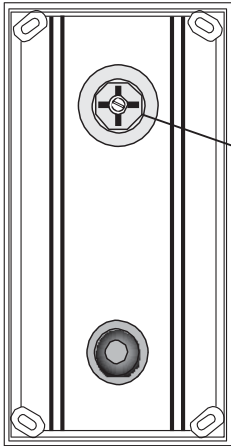

Use a screwdriver to loosen the screw and then adjust the angle of the camera ,then fix the screw.

5. System Wiring and Connections

5.1 Basic Connection

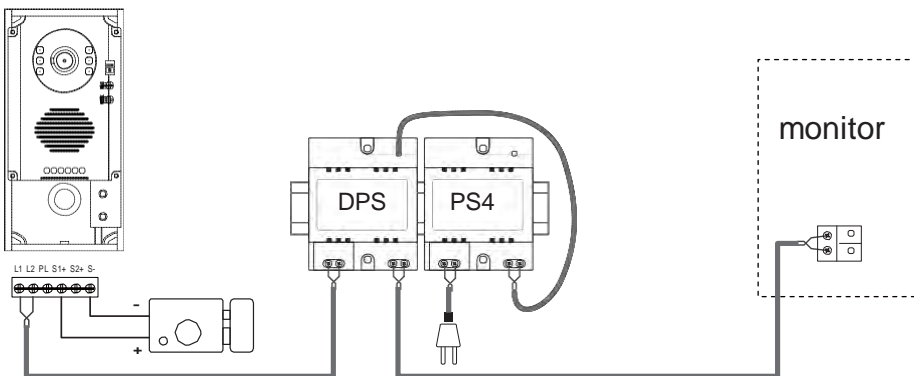

Connecting to a standard lock release

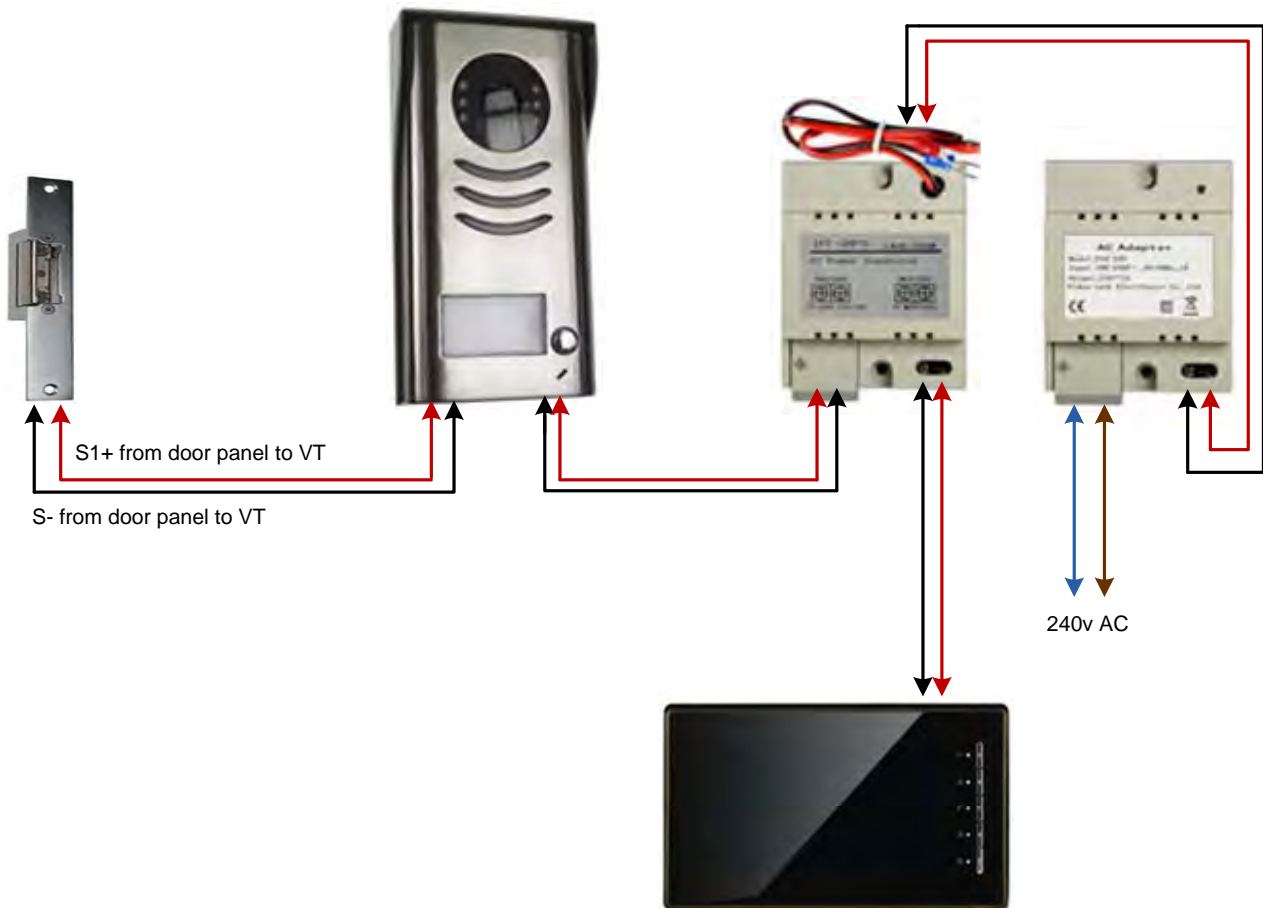

Connecting to a magnetic lock

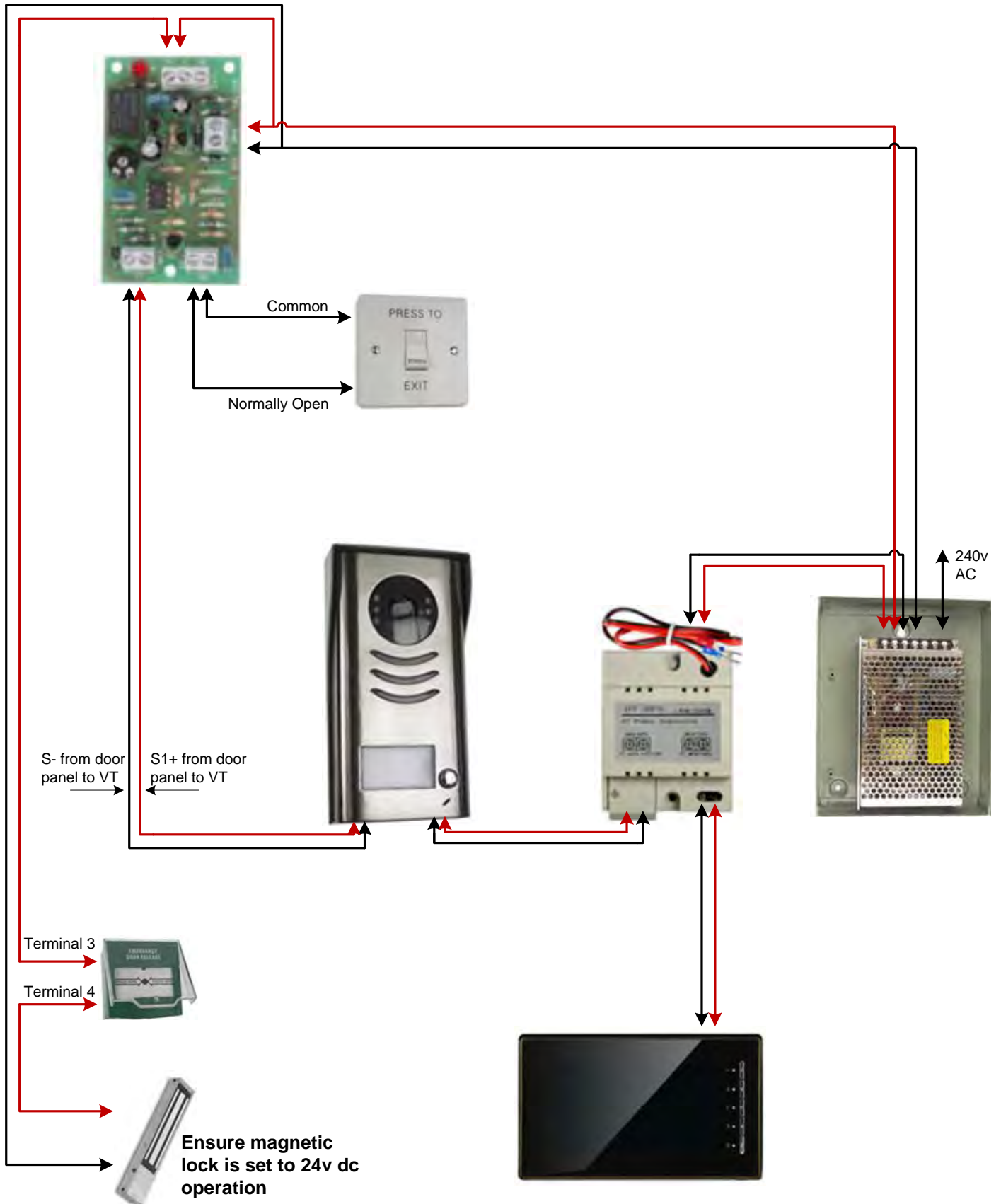

Connecting to an automated gate

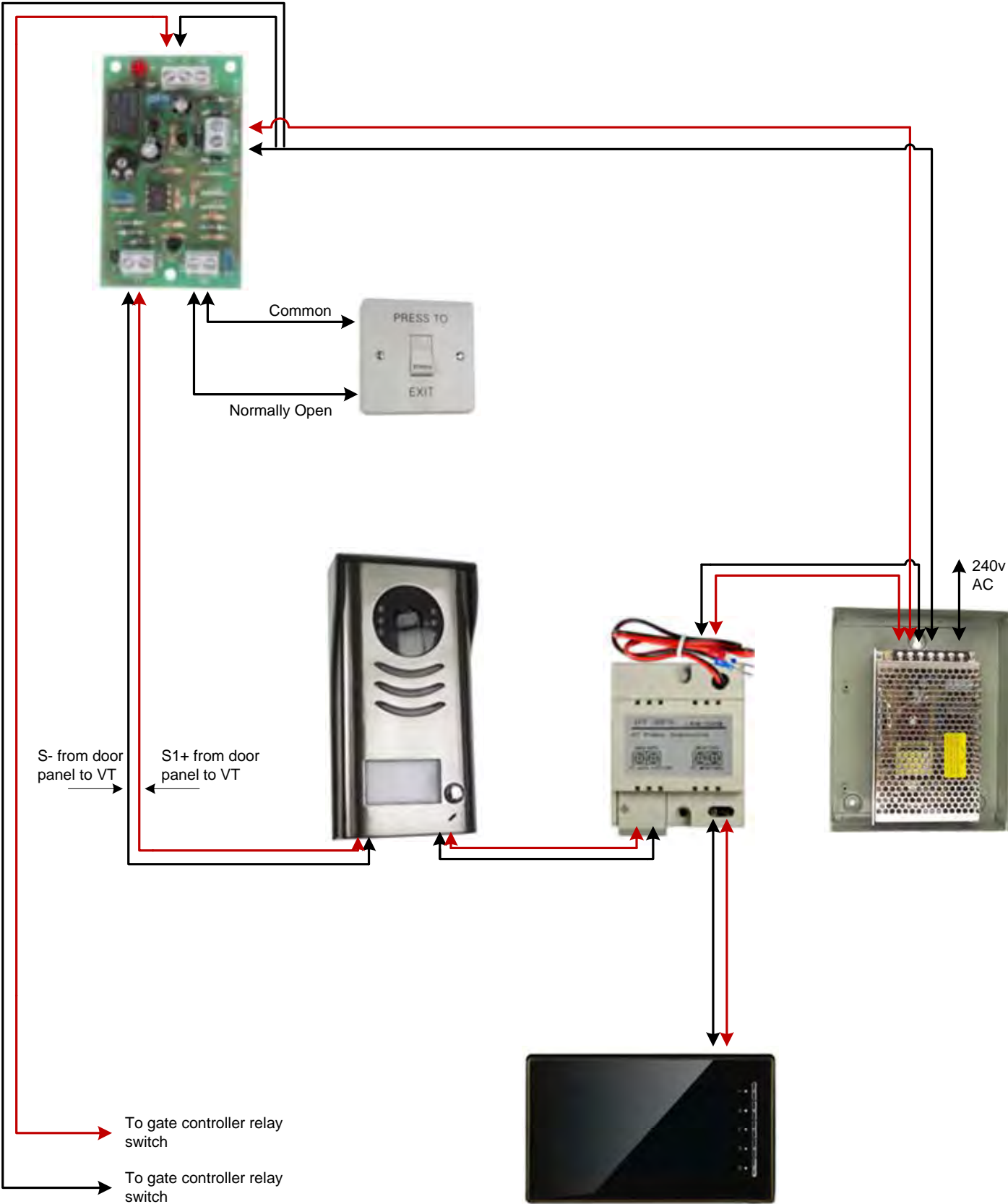

5.2 Electric Lock Connection

5.2.1 Door Lock Controlled with Internal Power

Note: Doorentryonline Ltd recommend an additional power supply for any magnetic lock used

1. Electronic lock of Power-on-to-unlock type should be used.
2. The door lock is limited to 12V, and holding current must be less than 250mA.
3. The door lock control is not timed from Exit Button(EB)
4. The **Unlock Mode** Parameter of Monitor must be set to 0 (by default)

connect one lock

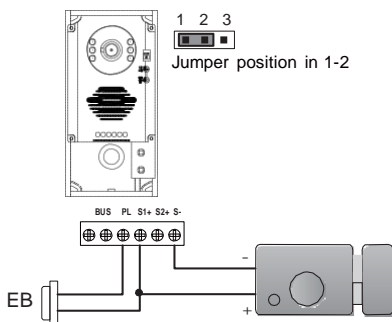

connect two locks

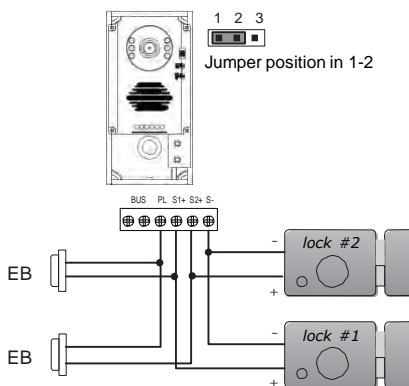

5.2.2 Door Lock Controlled with Dry Contact

Note:

1. The external power supply must be used according to the lock
 2. The inside relay contact is restricted to AC or DC 24V/3A
 3. The jumper must be taken off before connecting
 4. Setup the **Unlock Mode** of Monitor for different lock types
- Power-on-to-unlock type:Unlock Mode=0 (by default – fail secure)
 - Power-off-to-unlock type:Unlock Mode=1 (fail open)

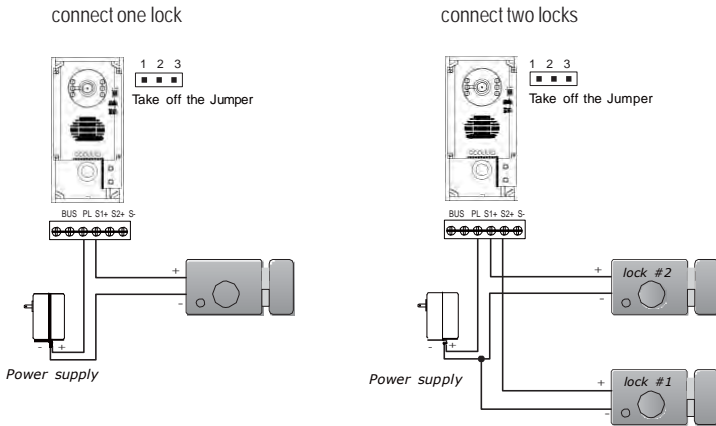

5.2.3 How to setup the unlock parameter in Monitor

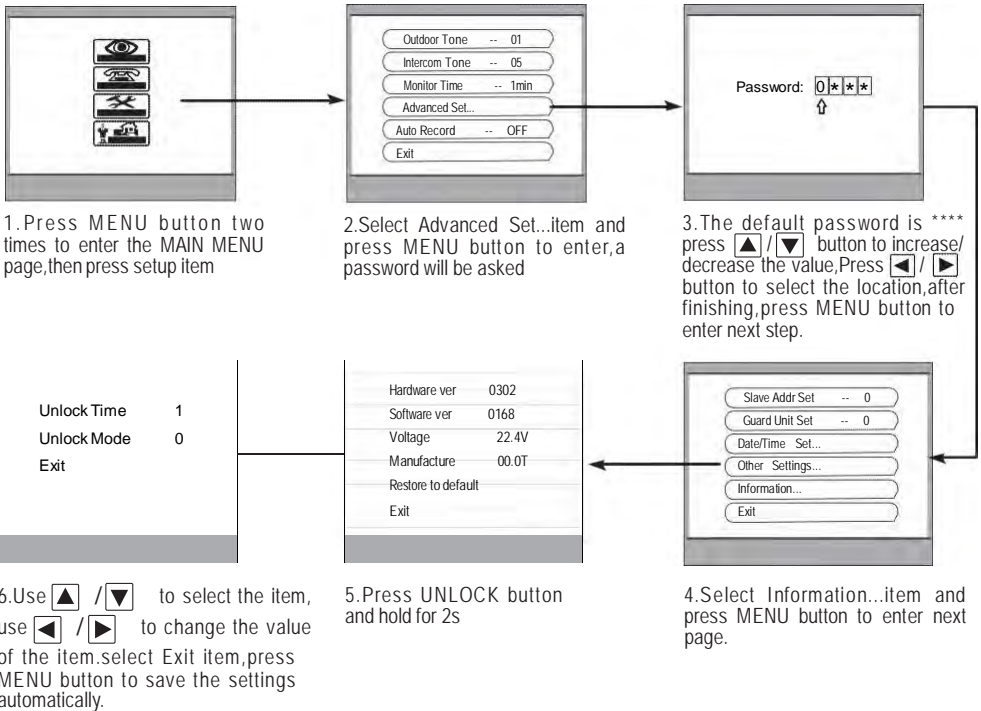

Note:

1. must connect DT591/592 completely before setting
2. the parameter will be saved in doorstation automatically, so you need only set on one monitor

2 WIRE VIDEO MONITOR

USER MANUAL

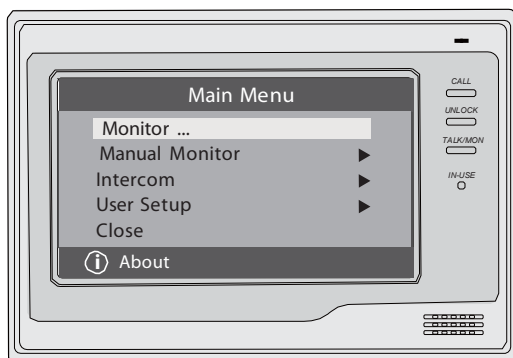

1. Parts and Functions

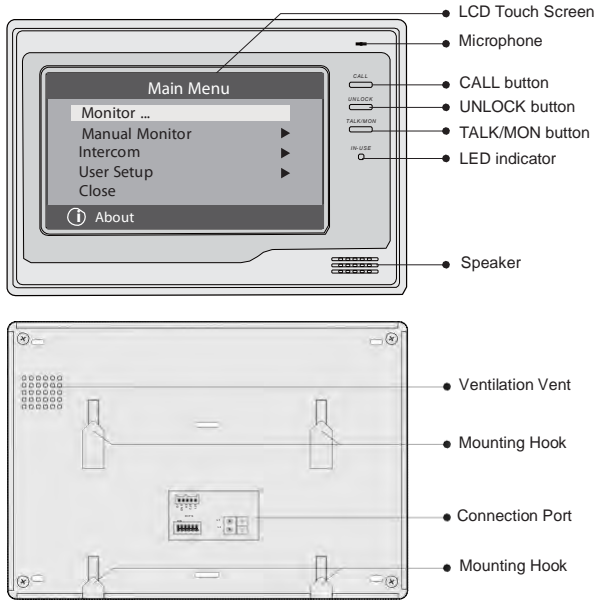

2. Monitor Mounting

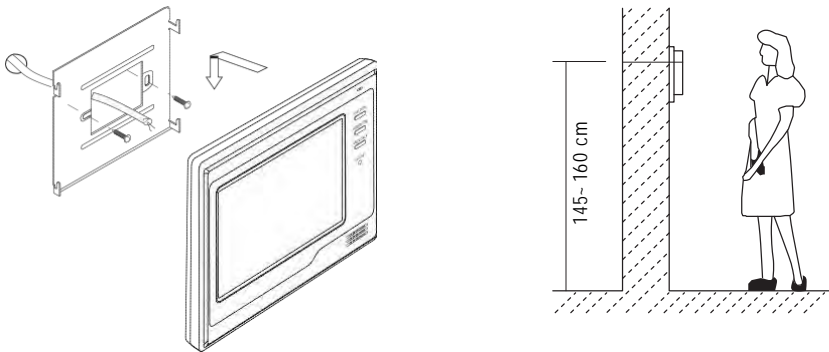



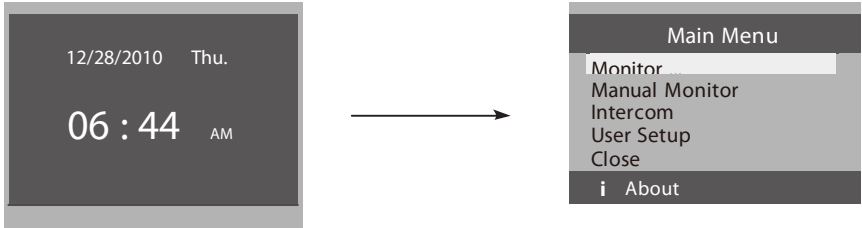

1. Use the screws to fix the Mounting Bracket on the mounting box.(fitting accessories includes a Bracket (Two pieces of 4X25 screws are needed for fastening the Mounting Bracket), Special 2 wire cables to connect with Monitor)
2. Wire the system correctly (see the later connection chapter) then hang the Monitor on the Mounting Bracket firmly.

3. Main Menu

1. Touch the screen anywhere on monitor in standby mode, the date/time page will be showed. (the date/time page will be closed in 1 minute if no operation)
2. Touch the screen again, main menu page will be showed as follows.



4. Basic Door Release Operation

1. Press **CALL** button on outdoor station, the Monitor rings, at the same time, the screen displays the visitor image.
2. Press **TALK/MON** Button on monitor or touch  icon on screen, you can communicate hands free with the visitor for 90 seconds. After finishing communication, press **TALK/MON** button again or touch  icon to end the communication. If nobody answers the phone, the screen will be turned off automatically after 30 seconds.
3. During talking state, Press **UNLOCK** Button or touch  or  icon to open the corresponding door for the visitor.
4. When the monitor is in standby mode, press **TALK/MON** Button(or touch **Monitor ...** item on main menu page), The screen can display the view of outside. If multi door stations are installed, touch  icon to get into the camera switch mode(or direct touch **Manual Monitor** item on main menu page). You can touch camera 1/2/3/4 to monitor the door station or CCTV camera you want. See the following diagrams.(Press **TALK/MON** button again to end monitoring.)

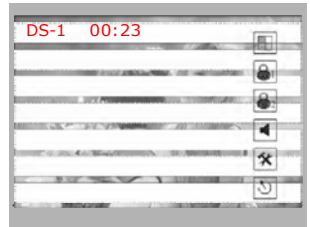

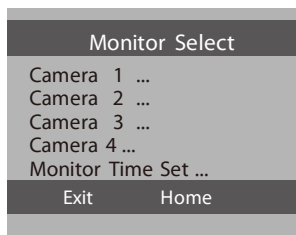
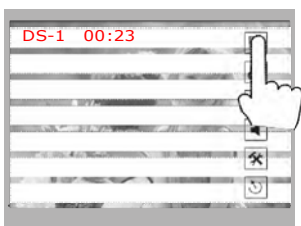

5. Intercom Function

When the monitor is in standby mode, press **CALL** Button to enter Intercom Function page(or direct touch **Intercom** item on main menu page).

1. **Intercom Call:** User in one apartment can call other apartments in the system. the name list will be created automatically by the system. Touch a name you want on the screen, then touch ☎ icon or press **CALL** Button on monitor to dial.(Note:1. touch ☎ icon or press CALL button again to redial. 2. Press TALK/MON button to cancel the call. 3.The DIP switches code of each monitor must set different.)





2. **Inner Call:** If multi Monitors are installed in the same apartment, select Inner Call, all the other Monitors will ring at the same time, whichever Monitor answers the call, conversation is started and the other monitors will stop ringing at the same time.(note: the DIP switches setting of all monitors must be same.)
3. **Direct Dial Guard unit:** A Monitor can be assigned as Guard Unit Monitor; when the Guard Unit Monitor answers the call, conversation with the guard person is started.

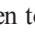

6. Basic Setup Instructions

Ring Tone Settings

Touch **User Setup** item on main menu page to enter setup page. Touch **Door Station Call Tone**, **Intercom Call Tone** or **DoorBell Tone** item, There are 12 ring tones that can be selected, touch a ring tone you want, then touch  icon to save and exit.(touch  icon to cancel the setting and return last page, touch  icon to get into main menu page)

Door Station Call Tone: set the ring tone calling from outdoor station.



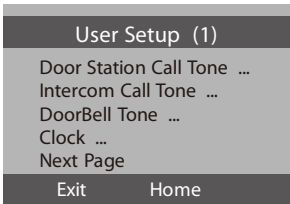

Intercom Tone: set the ring tone calling from other apartments.

DoorBell tone: set the ring tone calling from door bell.

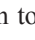

Ring Volume and Night Ring Volume Setting

You can set a ring volume for day time and night time individually, 6:00 AM~18:00 PM is the day time and 18:00 PM~6:00 AM is the night time by default, if you don't want to be disturbed at night, you can set the night ring volume to 0.

Touch **User Setup** item on main menu page to enter setup page, then touch **Next Page** item to enter User Setup 2 page, select **Ring Volume Setting** or **Night Ring Volume** item. then touch  /  icon to increase / decrease the value; After finish, touch  icon to save and exit.(touch  icon to cancel the setting and return last page, touch  icon to get into main menu page)

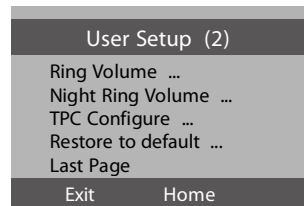



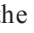

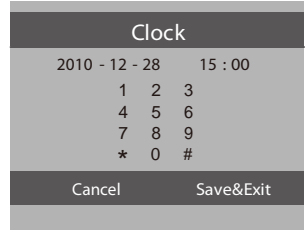
7. Date and Time Setting

Touch **User Setup** item on main menu page to enter setup page, touch **Clock...** item. a digital keypad will be showed on screen, input date and time by touching the digital keypad, use * icon to move the location. After finish, touch  icon to save and exit.(touch  icon to cancel the setting and return last page.)

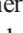

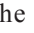

8. Monitor Time setting

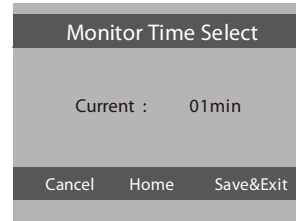
Touch **Manual Monitor** item on main menu page to get into camera switch mode, select **Monitor Time Set...** item. touch  /  icon to increase / decrease the value; After finish, touch  icon to save and exit.(touch  icon to cancel the setting and return last page, touch  icon to get into main menu page)



9. Restore to Default

Touch **User Setup** item on main menu page to enter setup page, then touch Next Page item to enter User Setup 2 page, touch **Restore to default** item ,a message will be asked to confirm the restore operation. If touch  icon ,All settings will be restored to default, if you don't want to restore, touch  icon to cancel the operation.(Note that the restore to default operation will not change the time setting and the dates.)

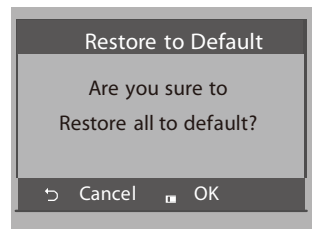
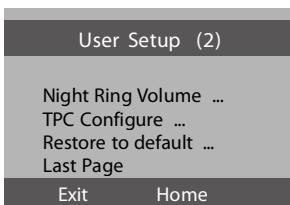

10. Unlock Parameter Setting

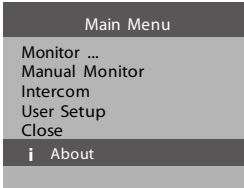

1.Touch User Setup item on main menu page.

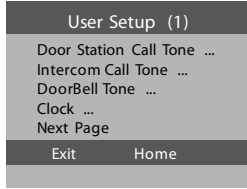

2.Touch Next Page item to enter next page menu.

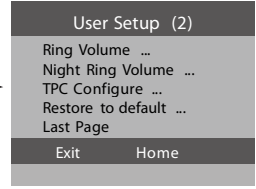

3.Touch Restore to default item, a message will be asked.

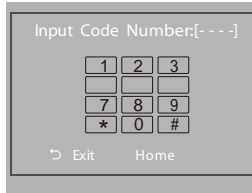

5.Input 4 digits code number by touching the digital keypad. ("*":cancel the input,"#":save the setting)



4.Press the UNLOCK button on monitor and hold for 2s.

Note:
8010 is used to set the unlock mode to 0. 8011 is used to set the unlock mode to 1.

11. Screen and Volume Adjustment

During monitoring or talking, touch  icon, the **ADJUST MENU** will be displayed. Select the adjustment item you want; touch  /  icon to decrease / increase the value.

- The first item is Scene mode selection: Total 4 screen modes can be selected in sequence: **Normal**, **User**, **Soft** and **Bright**. Whenever you modify **Brightness** or **colour**, **Scene** item will be set to **User** mode automatically.
- The **Brightness** and **Colour** item is for the image quality setting, adjust the value to get the best image you like.
- The **Ratio** item is for screen display adjustment, you can set to 16:9 or 4:3.
- The **Talk Volume** item is for talking volume adjustment.
- Note that all the modifications will be performed immediately after the operation. Touch  icon to exit the adjust page.

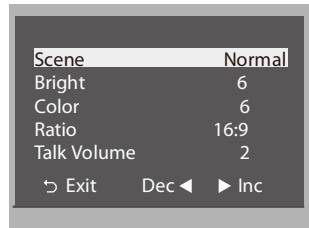

Additional Monitor Connections

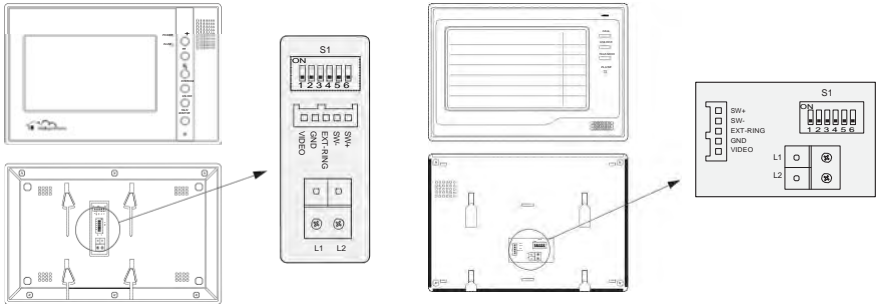

1. Door Bell Call Button

Additional door bell call button can be connected to the Monitor, so that the visitors can ring the door bell again in front of the user's apartment. When the call button is pressed, the Monitor will output ring tones but the screen will keep off, and the external ringer will ring at the same time (if a external ringer is installed).

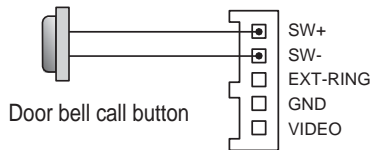

2. External Ringer

External ringer can be connected to the Monitor. The ringer will ring whenever the Door Station call button or the door bell call button is pressed, and it will stop ringing when the Monitor rejects or answers the call.

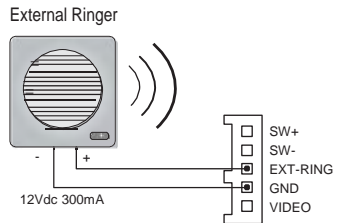

3. TV-out function

Connect television to the Monitor, when the Door Station calls, the user switch the channel to the AV channel, and the visitor's video will show up on the screen of the television. The core of the video cable must connect to the VD terminal, and the shielded layer connect to the GND.

