

Villa application

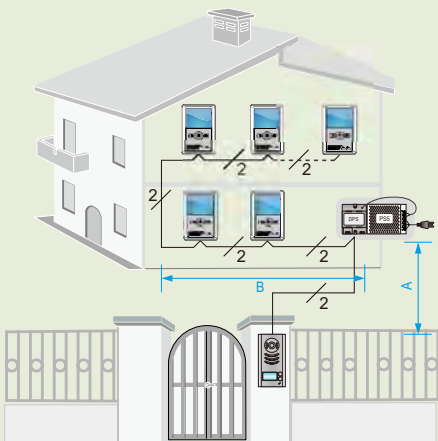

Cable and Distance

Cable	A(m)	B(m) ≤2 VT25	B(m) ≤16 VT25
CAT5 Cable (Combined)	40	80	—
Pair Cable (Parallel) 2X0.75 mm ²	30	50	—
Twisted Cable 2X0.75 mm ²	60	100	40
Twisted Cable 2X1.0 mm ²	80	120	60

Extending Monitors(up to 16)

In-Out topology:

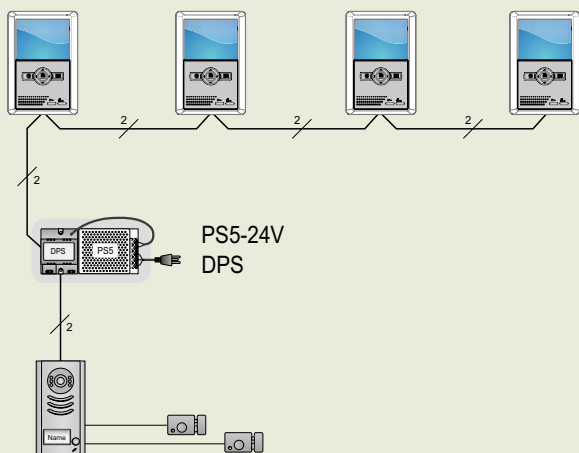

Star topology:

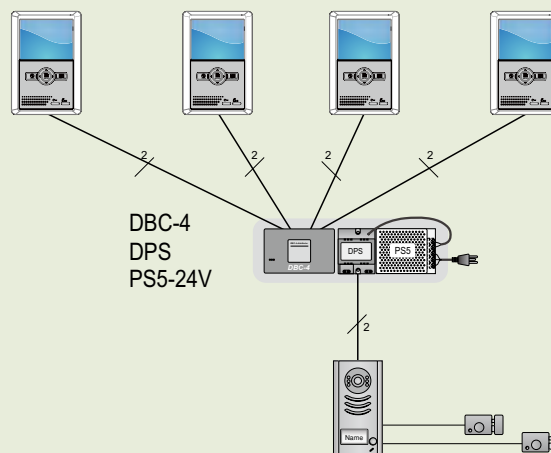

Extending Door/CCTV Cameras

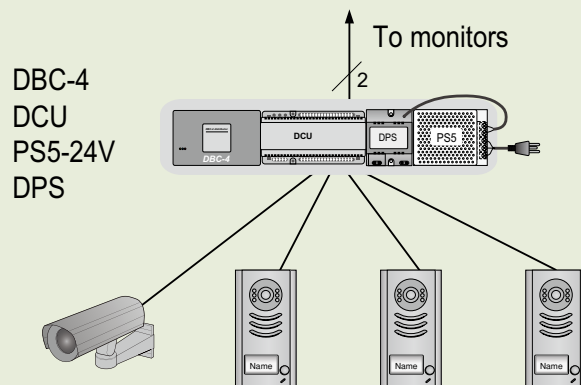
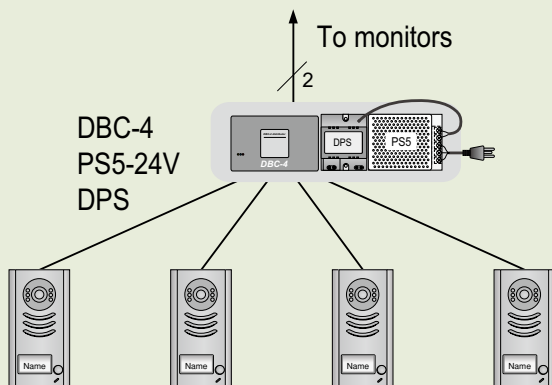

2-Wire Video System

596(F)/ID User Manual

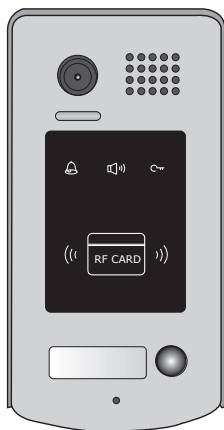

596/ID



596F/ID

1. Parts and Functions

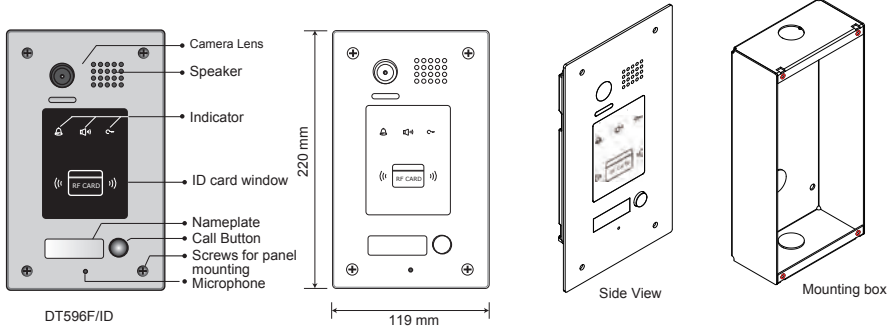
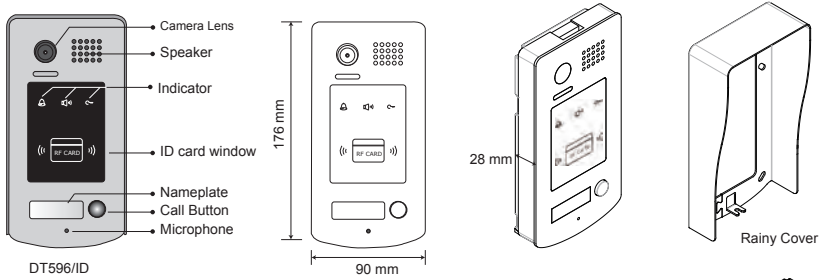

2. Terminal Descriptions

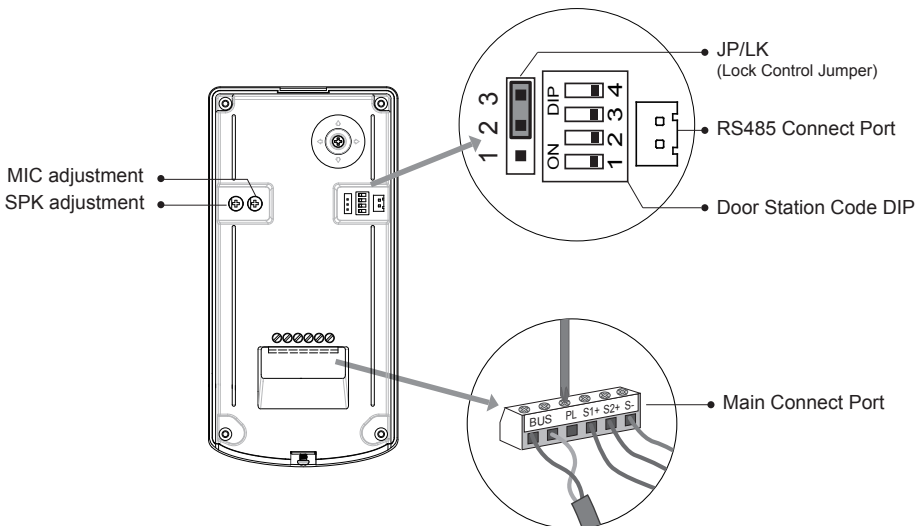

- **JP/LK(Lock Control Jumper):** To select the lock type: see section 4
- **Doorstation Code DIP:** Total 4 door stations can be supported, see section 5
- **RS485:** Used to update the program for door station
- **MIC:** Adjust the volume of Microphone
- **SPK:** Adjust the volume of Speaker
- **Main Connect Port:** To connect the bus line and the electronic locks.
- **BUS:** Connect to the bus line, no polarity.
- **PL:** External lock power input, connect to the power positive(power +).
- **S1+, S2+:** Lock power(+) output, to connect 2 locks.
- **S-:** Lock power(-) output, connect to the power(-) input of locks(only when using the camera to power the locks, if using the external power supply for the locks, the S- will not be connected).

3. Door Station Mounting

DT596/ID Mounting

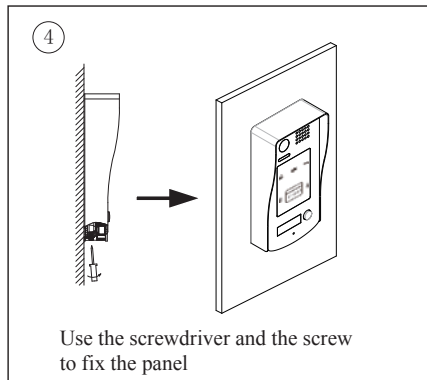
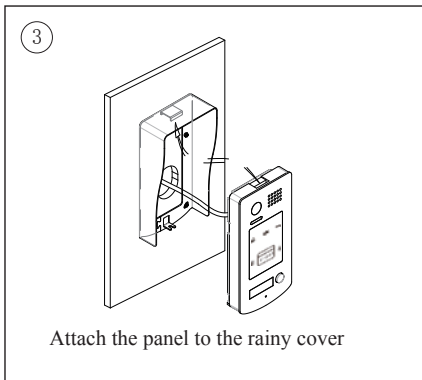
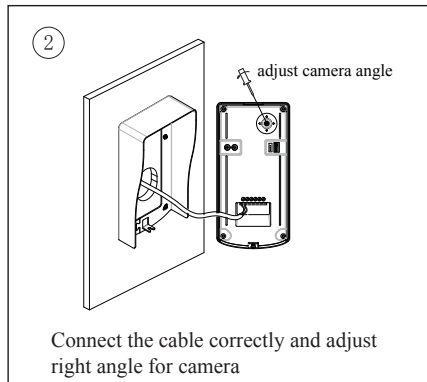
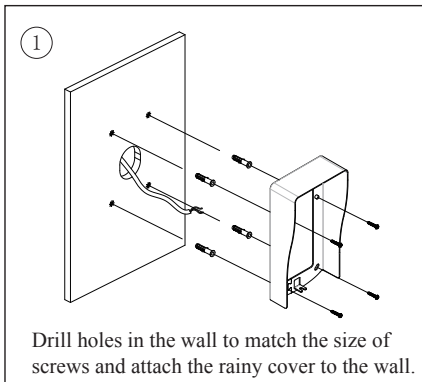

DT596F/ID Mounting

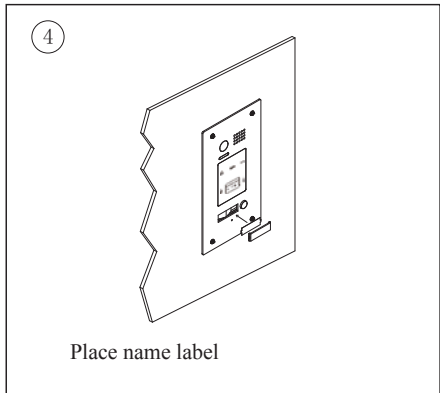
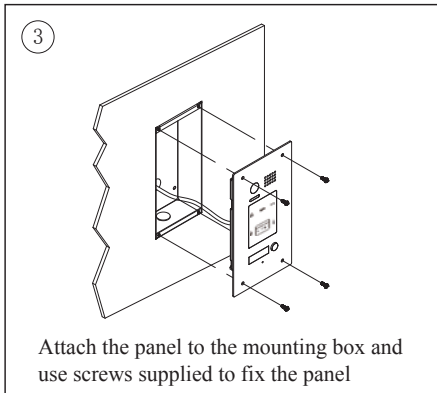
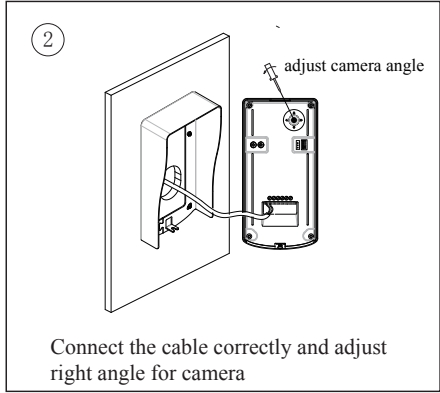
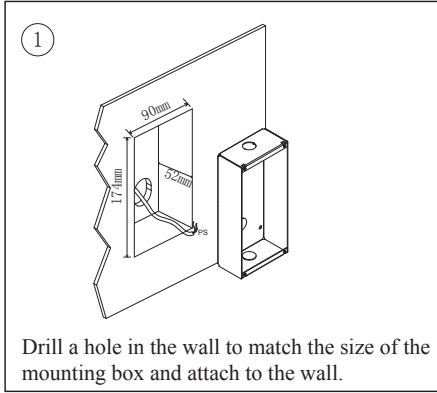

Adjusting Camera Angle

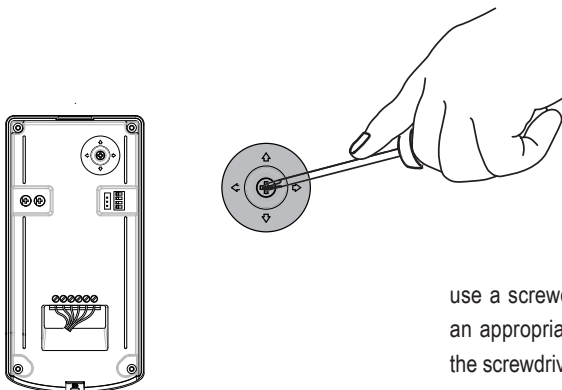

use a screwdriver to loosen the screw, then adjust an appropriate camera angle, after finishing, use the screwdriver to fix the screw.

Connecting to a standard lock release

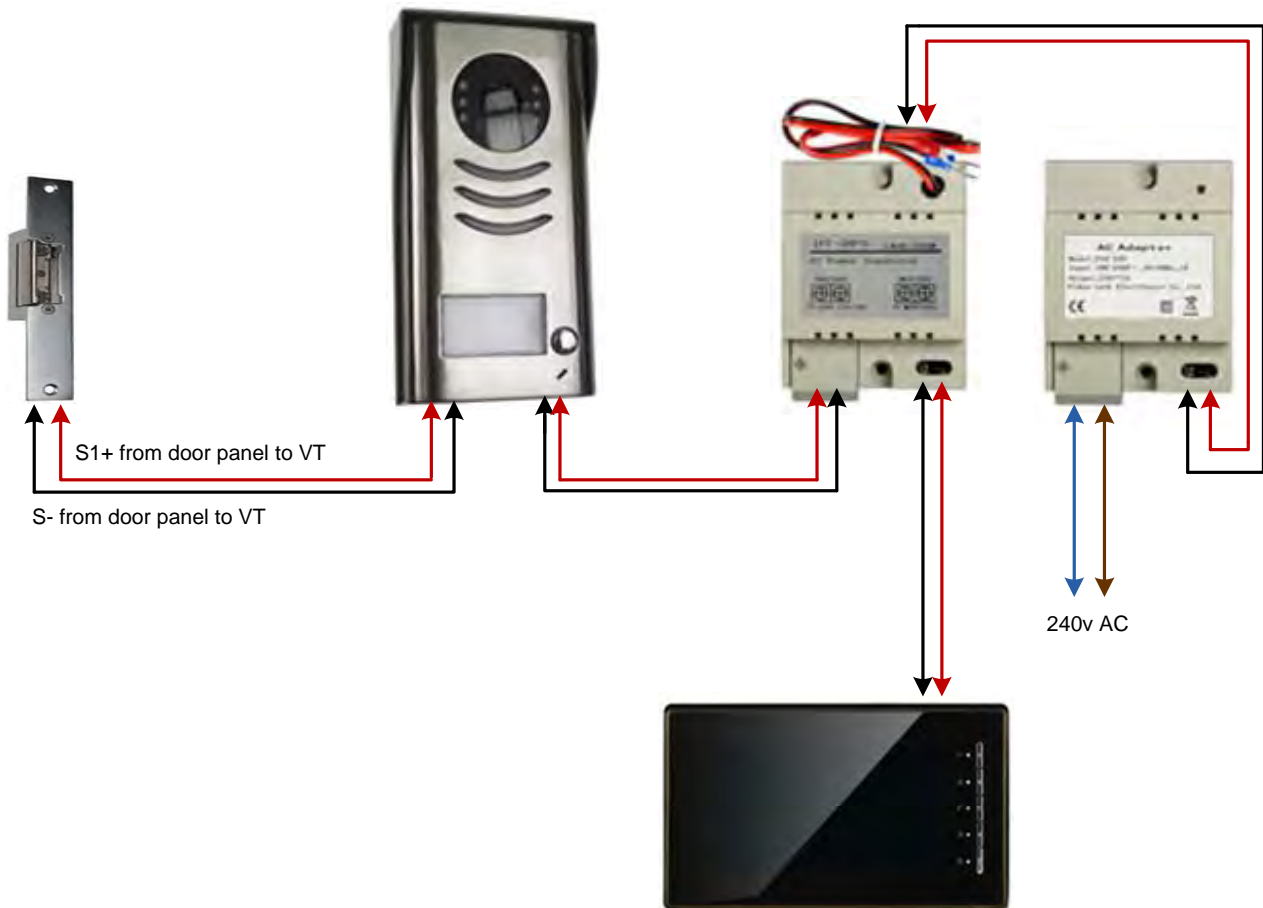

Connecting to a magnetic lock

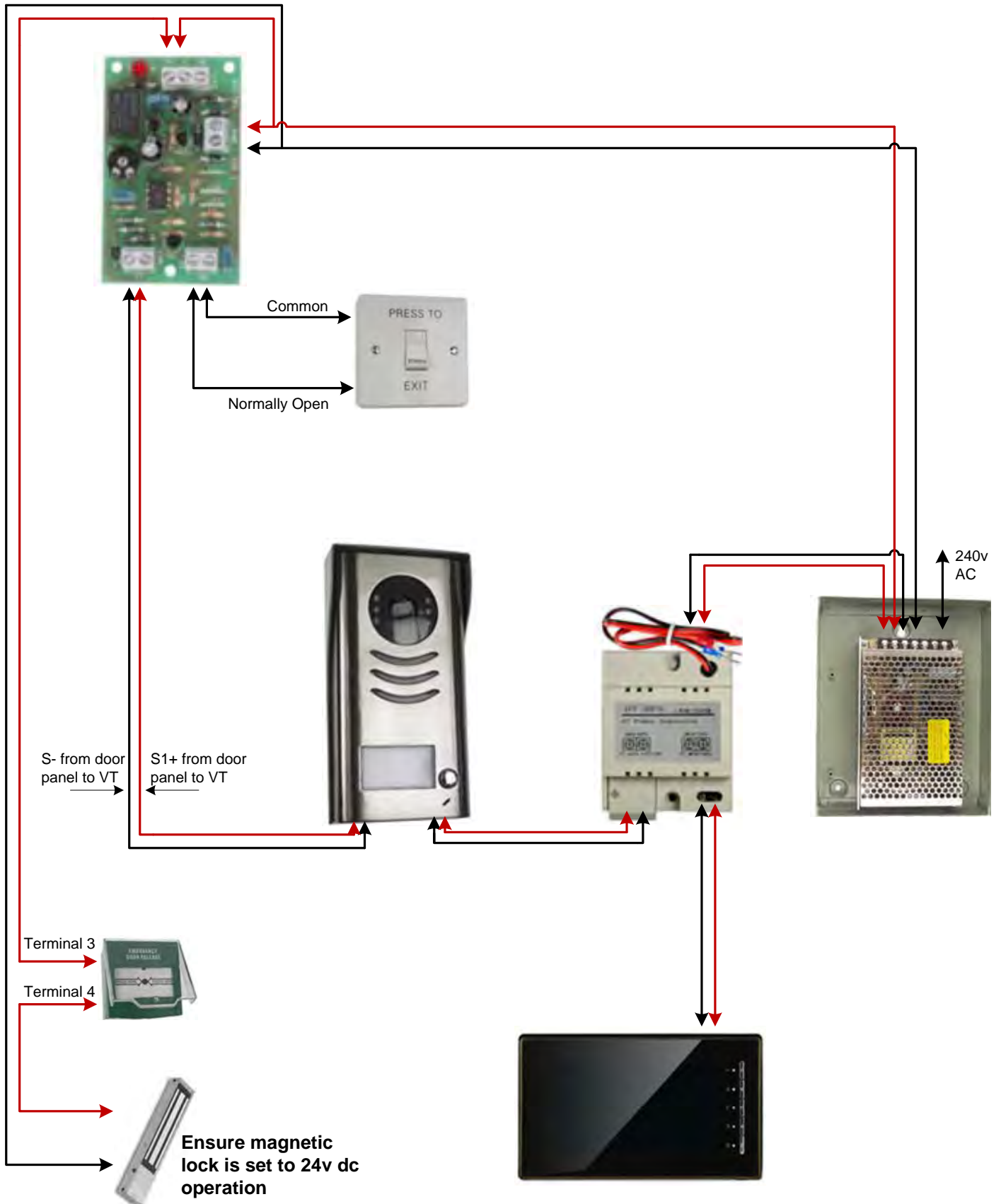

Connecting to an automated gate

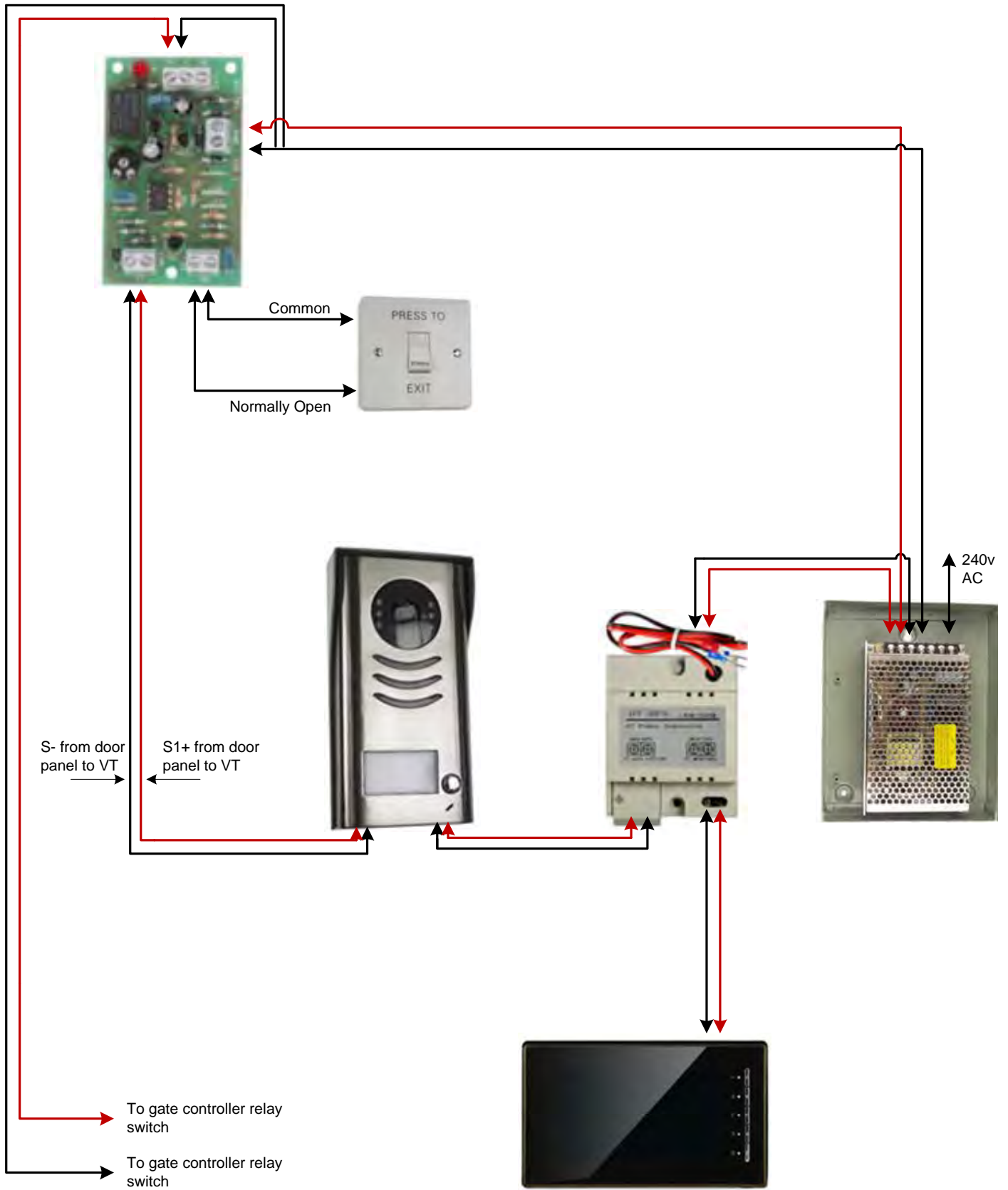

connect one lock

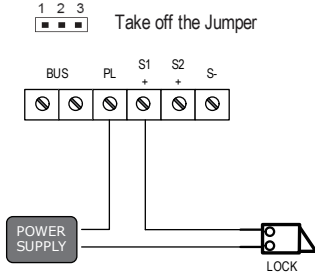

connect two locks

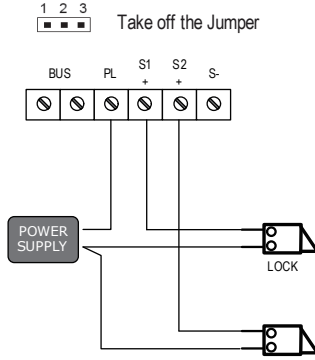

Unlock parameter setting(set on monitor)

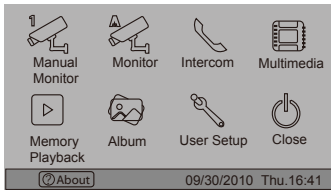

1. Touch **i** About item on main menu page.



2. Touch the screen anywhere and hold for 2s.

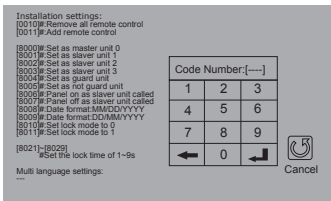

4. A digital keypad and setting instructions will be showed.

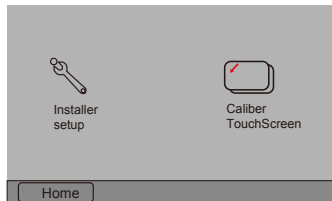

3. Touch Installer setup item

Note:

1. must connect DT596(F)/ID correctly before setting.
2. the parameter will be saved in DT596(F)/ID automatically, so you need only set on one monitor.
3. the above diagram is fit for icon menu series monitors only, to text menu series monitors, please refer to the corresponding user manual.

5.DIP Switches Setting

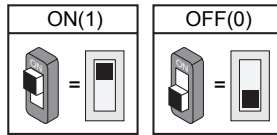

DIP Switches Settings of Door Station



Total 4 bits on the DIP switches can be configured. The switches can be modified either before or after installation.

Setting Item	Bit state	Descriptions
Bit1 and Bit2 (it is used to set the ID code for door station)		Default setting, ID = 0(00), set to the first Door Station.
		ID = 1(10), set to the second Door Station.
		ID = 2(01), set to the third Door Station.
		ID = 3(11), set to the fourth Door Station.
Bit3		The relay 2 doesn't respond the second lock, showing user cards controlled two locks or pressing unlock 2nd on monitor can not release the second lock. During this time, after continuously showing access card 10 times, the relay 2 will be closed for 60 seconds, the blue LED-relay 2 will be illuminated for 60 seconds, and the buzzer will continuously sound. If the system is connected alarm, the alarm function will be activated.
		The relay 2 responds the second lock.
Bit4		Used to authorize master card









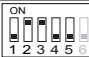
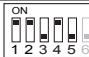

DIP Switches Settings of Monitor

There are 6 bit switches in total. The DIP switches are used to configure the user code for each Monitor.

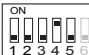
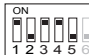
Bit-6 is used to match the video impedance, which have to be set to on if the monitor is in the end of the bus, otherwise set to off.

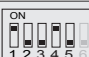
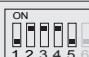
Bit state	Setting	Bit state	Setting
	The monitor is not at the end of the bus.		The monitor is at the end of the bus.

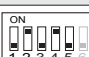
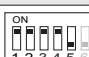
Bit-1 to Bit-5 are used to User Code setting. The DT596(F)/ID responds to 0~15 .

Bit state	User Code	Bit state	User Code	Bit state	User Code
	Code=0		Code=6		Code=11
	Code=1		Code=7		Code=12
	Code=2		Code=8		Code=13
	Code=3		Code=9		Code=14
	Code=4		Code=10		Code=15
	Code=5				

6. ID Card Registration

Introduction:

- Up to 1000 user cards can be registered by the door station.
- Easy management with LED status and sound hints.
- There are two master cards, one MASTER CARD ADD card and one MASTER CARD DELETE card, When registered new master cards, the old master cards are invalid automatically.
- Card reading distance is from 3 to 5 cm.
- The master cards are necessary when you add or delete user cards. Please keep it well for future use.



Add User Cards:

1. Control one lock (the first lock)

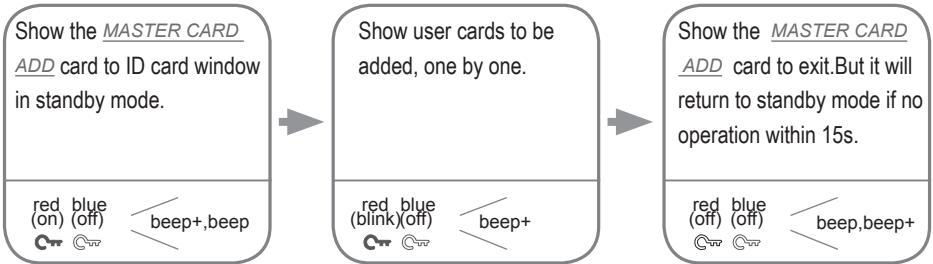

2. Control two locks

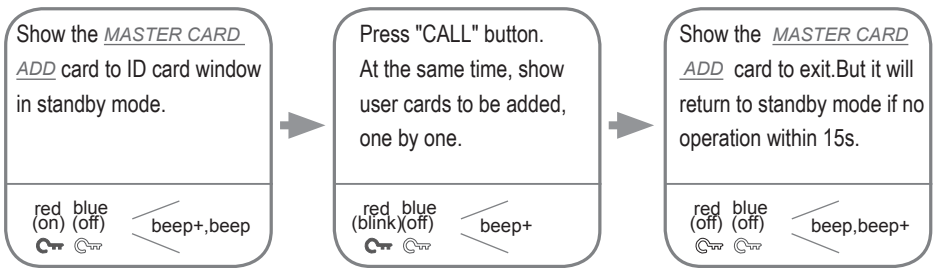

Delete User Cards:

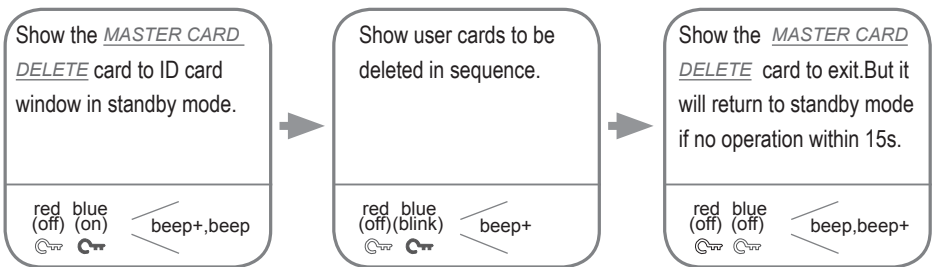

Access Initialization (delete all user cards):

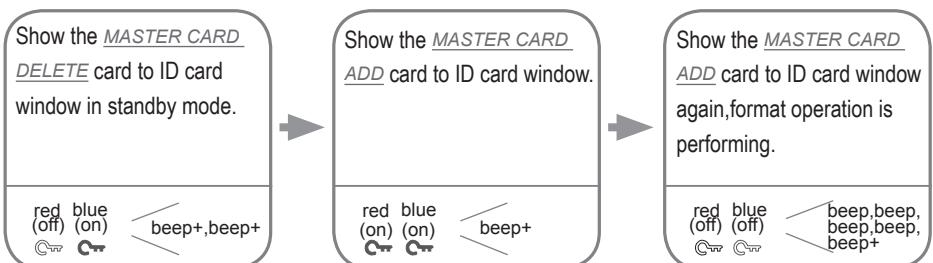

Authorize master cards:

By default, there are two master cards marked *MASTER CARD ADD* and *MASTER CARD DELETE*, but you should know that the master card can be authorized by users at any time. That means any two user cards can be authorized to master cards. When registered new master cards, the old master cards are invalid automatically.

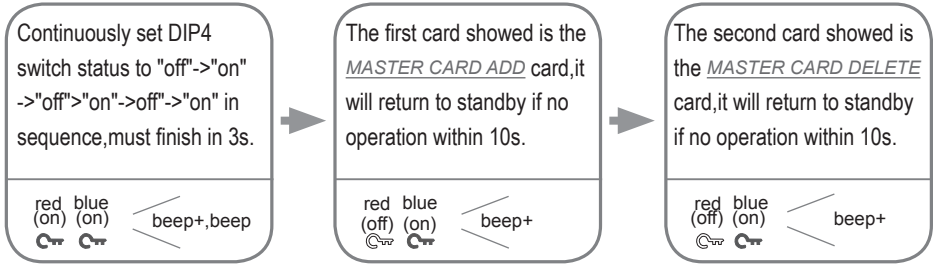

7.Unlock Operations

Unlocking of ID Card

When the registered user card has been shown to ID card window, the LED indicator (the first lock:red; the second lock:blue) lights up, the buzzer sounds, and the electric door strike is unlocked.

Note1:if the user card control one lock only, show the user card to release the first lock. red indicator lights up.

Note2:if the user card control two locks, show the user card to ID card window in standby mode, the red&blue indicator blink for 1.5s alternately. During this time, press "CALL" button to release the second lock. Otherwise, release the first lock if there isn't any operation within 1.5 seconds.

Example:release the first lock

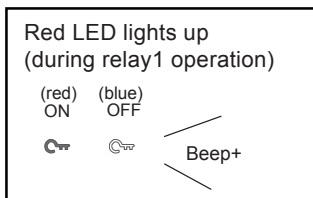

Example:release the second lock

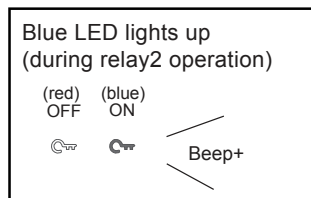

- If 10 times unauthorized access cards are continuously attempted, the release function is forbidden and the showing card operation is disabled for 60 seconds.
- When DIP3 switch is set to 1, the relay 2 doesn't respond the second lock, that's to say, showing user cards controlled two locks or pressing unlock 2nd on monitor can not release the second lock. During this time, after continuously showing access card 10 times, the relay 2 will be closed for 60 seconds, the blue LED-relay 2 will be illuminated for 60 seconds, and the buzzer will continuously sound about 8 times. If the system is connected alarm, the alarm function will be activated.

- You can activate the electric door strike by pressing the request to exit button connected to the unit. Pressing request to exit button 1 releases relay 1, and pressing request to exit button 2 releases relay 2.(The unlock function will work when the request to exit button is pushed, even while the proximity access is forbidden.



1. If show the authorized user card,the buzzer will sound of beep+,and the LED indicator will light up.
2. If show the unauthorized user card,the buzzer will sound of beep,beep,beep.

8. Precautions

- Please clean the unit with soft cotton cloth, don't use the organic impregnant or chemical clean agent. If necessary, please use a little pure water or dilute soap water to clean the dust.
- The unit is weather resistant. However do not spray high pressure water on access control keypad directly. Excessive moisture may cause problems with the unit.
- You must use the right adaptor which is supplied by the manufacture or approved by the manufacture..
- Pay attention to the high voltage inside the products, please refer service only to a trained and qualified professional.

9. Specifications

- | | |
|-----------------------------|--|
| • Power Supply : | DC 24V (supplied by PS4-24V or PS5-24V); |
| • Power Consumption: | Standby 60mA; Working status 200mA; |
| • Camera: | Pinhole Sharp Color CCD; 420 TV Lines; |
| • Lock Power supply: | 12Vdc, 300mA(Internal Power); |
| • Number of relay circuits: | 2 |
| • Mounting: | Surface mounting(DT596/ID)
Flush mounting (DT596F/ID) |
| • Working temperature: | -10°C ~ +45°C |
| • Wiring: | 2 wires,non-polarity |
| • Dimension: | 176(H)×90(W)×28(D)mm(DT596/ID)
220(H)×119(W)×52(D)mm(DT596F/ID) |

10. Cables Requirements

The maximum distance of the wiring is limited in the DT system. Using different cables may also affect the maximum distance which the system can reach.

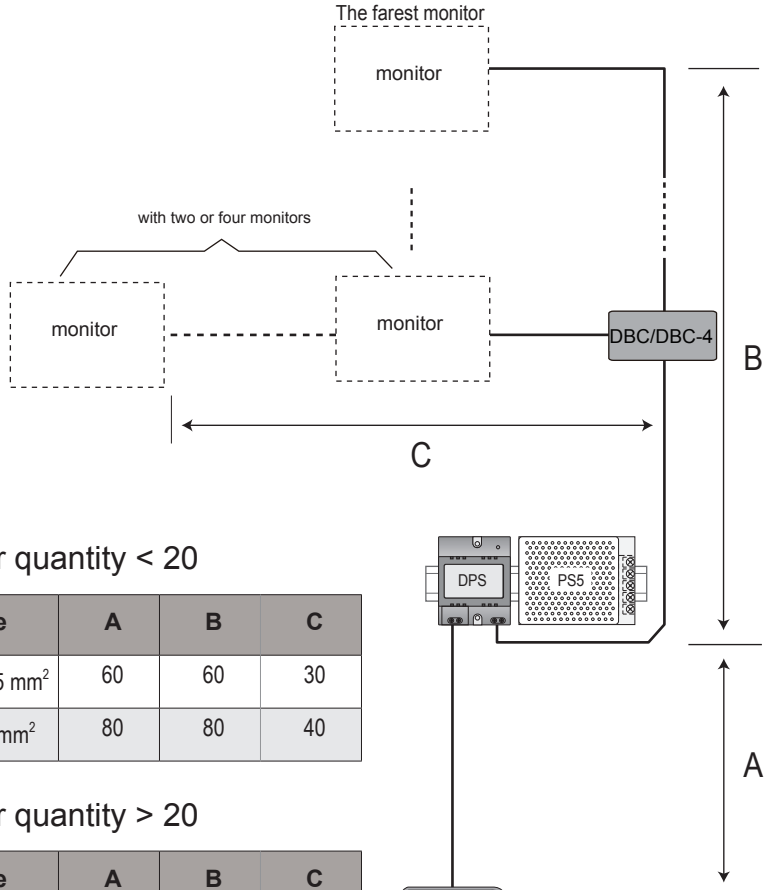

When Monitor quantity < 20

Cable Usage	A	B	C
Twisted cable 2x0.75 mm ²	60	60	30
Twisted cable 2x1 mm ²	80	80	40

When Monitor quantity > 20

Cable Usage	A	B	C
Twisted cable 2x1 mm ²	70	30	20
Twisted cable 2x1.5 mm ²	70	50	30

Note: If the monitor has been specified the distance, refer to the parameter.

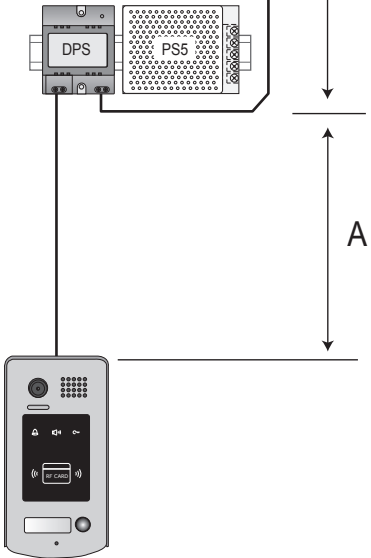

2 WIRE VIDEO MONITOR

USER MANUAL

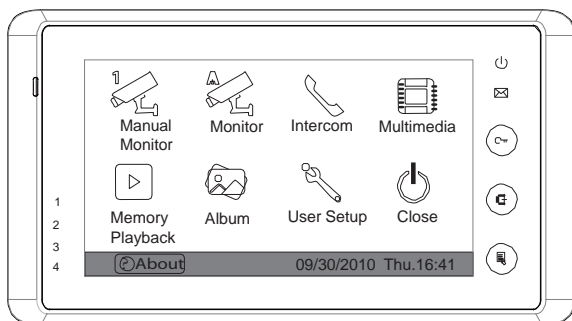

CONTENTS

1. Parts and Functions	1
2. Monitor Mounting	1
3. Operation Instructions	2
4. Basic Setup Instructions	4
5. Built-in Memory and SD Card	7
6. Specification	9

Please read this manual carefully before using the product, and keep it well.

1. Parts and Functions

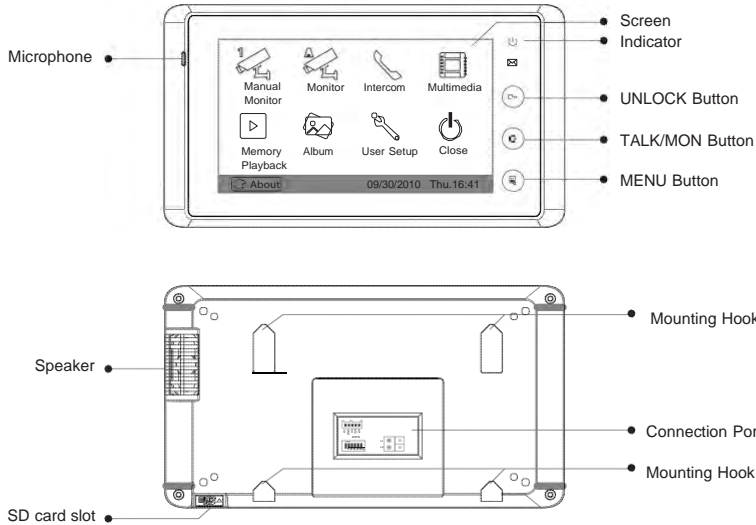

2. Monitor Mounting

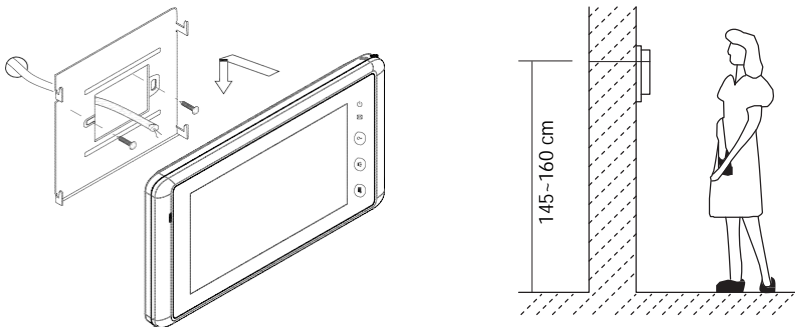

- Use the screws to fix the Mounting Bracket on the wall.(accessories include a Bracket, two 4X25 screws (use to fasten the Mounting Bracket), 2 wire cables (use to connect with Monitor)).
- Connect the system correctly. then hang the Monitor on the Mounting Bracket firmly.



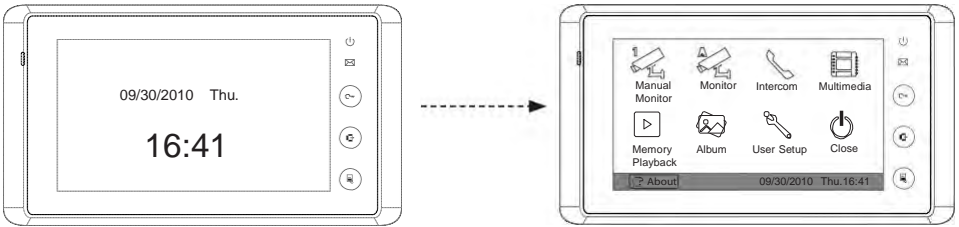

3. Operation Instructions

How to Enter Main Menu

- Touch the screen anywhere (or press  MENU button) in standby mode, a full screen calendar will be showed.
- Touch the screen again (or press  MENU button again) to enter main menu.



Answering a Door Call





- Press CALL button on door station. The monitor rings, and the visitor's image will be seen on screen. If nobody answers the call, the screen will turn off in 30 seconds automatically.
- Press  TALK/MON Button or touch  icon, you can talk with the visitor for 90 seconds. During talking state, press  TALK/MON Button again or press  icon again to end the conversation. If the system connects two or more Monitors, pick up any Monitor, the others will be automatically shut off.



Door Release



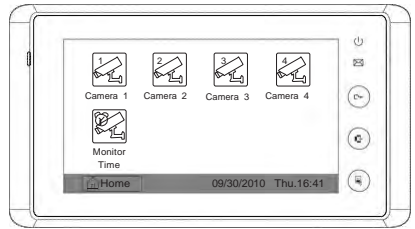

- During the conversation, press UNLOCK Button or touch  icon to unlock the door. (if two locks are connected to door camera, touch  unlock 2nd icon to release the second lock)

Entrance Monitoring

Press  TALK/MON button on monitor in standby mode, or touch  **Monitor** icon on main menu. the screen will display the view of the Outdoor Station. During monitoring, touch  **Manual Monitor** icon to get into the camera switching mode, (or directly touch  **Manual Monitor** icon on main menu page). if multi Door Stations are installed, you can press the camera 1/2/3/4 to monitor the Door Station or CCTV camera you want. press  **Home** icon to exit and enter main menu page.

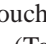

Intercom Function

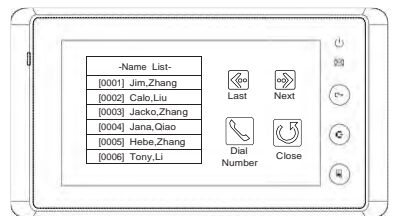
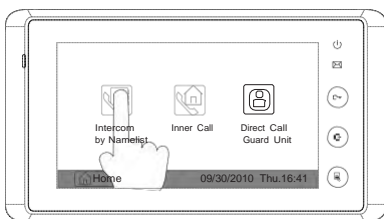

- **Intercom Call by namelist:** User in one apartment can call other apartments in the system. Touch  **Intercom** item on main menu page, then touch  **Intercom by Namelist** icon (the namelist will be created automatically by the system). Select a name on the screen then touch  **Dial Number** icon to call. Press  icon to enter last/next name list page. (Touch  **Dial Number** icon again to redial)



- **Inner Call:** If multi Monitors are installed in one user, select and press the Inner Call item, the other Monitors will ring at the same time, whichever Monitor answers the call, conversation is started, and the other monitors will stop ringing at the same time.
- **Direct Dial Guard unit:** A Monitor can be assigned as Guard Unit Monitor; when the Guard Unit Monitor answers the call, conversation with the guard person is started..

4. Basic Setup Instructions





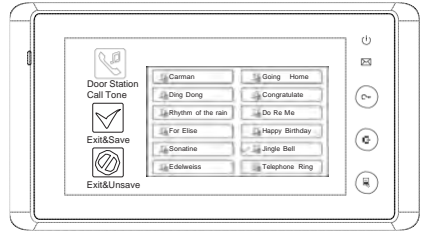

Ring Tone Setting

- Touch  **User Setup** icon on main menu page to enter call tone setting screen, touch Door station call tone/intercom call tone/door bell call tone, 12 pieces ring tones will be displayed, Choose a ring tone which you want, then touch  icon to save and exit, the ring tone will be performed. or touch  icon to unsave and exit.









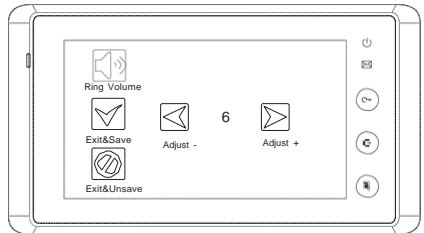

Ring Volume Setting

Ring Volume

You can set a ring volume for day time, 6:00 AM~18:00 PM is the day time by default, enter main menu page, then touch  **User Setup** icon to enter next page, and then touch  **Ring Volume** icon to enter Ring Volume page, Use   icon to decrease/increase the volume. then touch  icon to save and exit, or touch  icon to unsave and exit.





Night Ring Volume

You can active a ring volume for night time, 18:00 PM~6:00 AM is the night time by default, if you don't want to be disturbed at night, you can set the volume to 0. Enter main menu page, touch  **User Setup** icon to enter next page, then touch  **Night Ring Volume** icon to enter Night Ring Volume page, Use   icon to decrease/increase the volume. After setting a value you want, you should touch  **Ring Volume** icon to active the setting, after that the Ring Volume  icon will change to Night Ring Volume  icon. then touch  icon to save and exit, night ring volume will be performed. or touch  icon to unsave and exit.

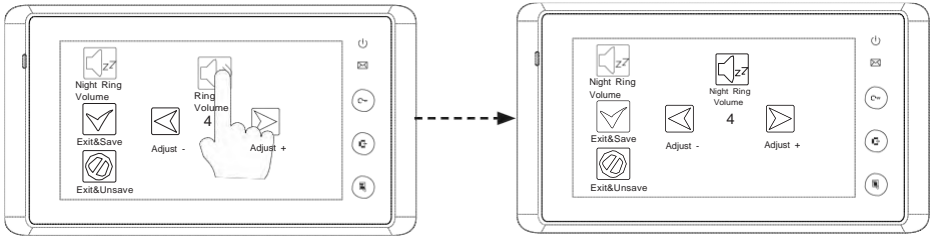
Note: touch  **Night Ring Volume** icon again, you can cancel the night ring volume setting.



Monitor Time Setting



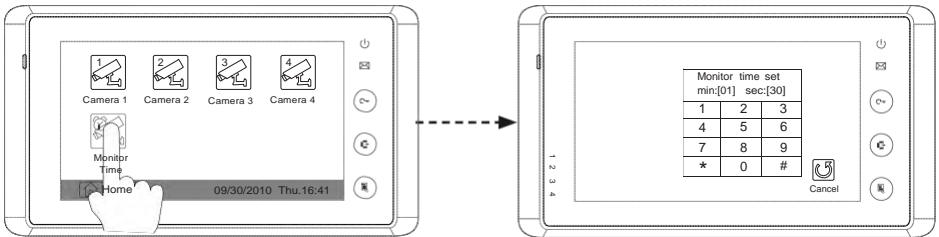

- Enter main menu page, then Touch  **Manual Monitor** icon to enter next page. then press  **Monitor Time** icon to enter monitor time setting page.
- Input digitals by pressing the digital keypad, and press * icon to change the setting location, and press # icon to save. Settings will be performed immediately, press  icon to return last page .

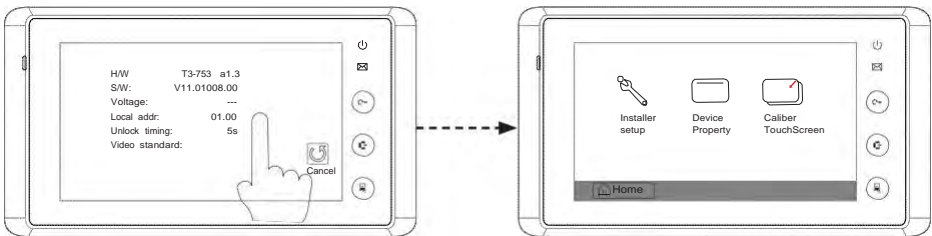

Unlock Parameter Setting





- Enter main menu page, then Touch  **About** icon to enter next page. and then touch the screen anywhere and hold for 3s to enter next menu.

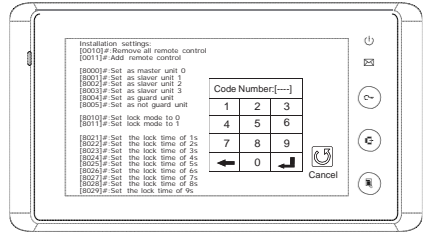

- Touch  **Installer setup** icon,a digital keypad and installation setting will be showed on screen.
- Input code number by touching the digital keypad.According to the left instructions, 8010 and 8011 are used to set the unlock mode(0 and 1). 8021~8029 are used to set the unlock time (1s~9s) .use  to cancel the input,and use  to save the setting. Touch  icon to return last page .



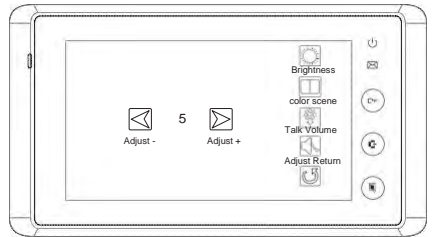

Screen Setting

When the Monitor is in monitoring or talking state, Press  **Adjust** icon to enter screen setting page.Touch any item you want,then touch   to decrease or increase the value.Settings will be performed immediately. Press  icon to exit out the page.



Restore to Default

The restore to default function allows the user to recover the settings to factory setting.Note that the restore to default operation will not change the time setting and the datas on built-in memory or SD card.

Enter main menu page,then touch  **User Setup** icon to enter the setting page,press Restore to default item, the default settings will be loaded. press  **Home** icon to return to home screen page.

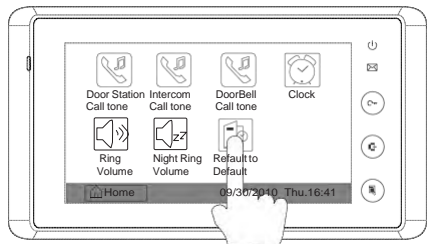

5. Built-in Memory and SD Card

This Monitor has been equipped with a built-in memory (about 120 MB) together with a SD card reader. Maximum 16 GB SD card can be supported.

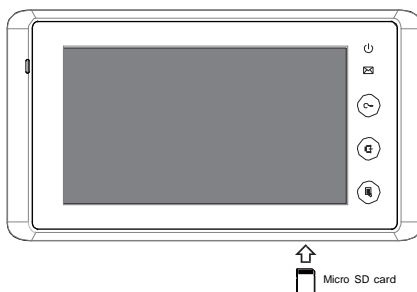

- The monitor can play photos and pictures.
- Photo frame function, each photo playing will last 5 seconds, More pictures in the SD card, longer time for triggering the function, 800 pictures is supported in inner memory. With 2G SD card,more than 30000 pictures can be supported.
- Must use T-views album software tool to transform the JPG format photos took by digital camera to TVS format photos that can be viewed on Monitor.
- The captured pictures will be saved in a folder named by date,note that the pictures recording every day will be saved in different folders which automatically generated every day.
- The captured pictures in the built-in memory can be copied to the SD card, and you should use T-views memo software tool to convert the pictures to JPG format that can be seen on the computer. (select the pictures(press Ctrl+A to select all)->>click the right key of the mouse ->>choose transfer selected to JPG item->>save the pictures on computer)
- When the built-in memory is full,the oldest picture will be deleted to make room for new record .
- The built-in memory can be formatted by the Monitor,but SD card cannot,you should format the SD card on computer.
- Avoid to plug in/out the SD card when the monitor is under operation.
- Playing will be interrupted by the calling from outdoor station.

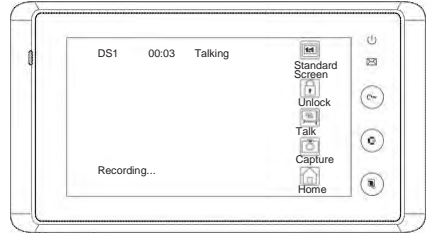

Picture Recording

Both Auto-Recording and Manual-Recording are available, and Auto-Recording is default. If receive a Call, after 3s, the monitor will record automatically. or you can touch  **Capture** icon to record the visitor's image manually.









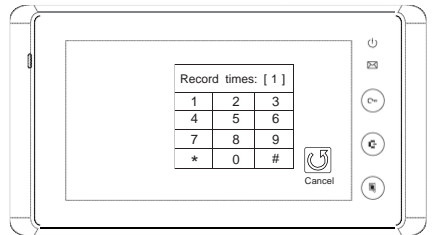

Record times Setting

You can setup Memo Options to choose 1/4/8 pictures memo. If 4/8 was chosen, you will have 4/8 shots for each recording operation, and every 1.5 seconds catch a picture.

Touch  **Multi Media** icon on main menu to enter next page, then touch  **Memory Options** icon, a digital keypad will be showed on the screen, you can only set the record times for 1/4/8 by touching the digital keypad. touching other digitals are unvalid .and press # icon to save. Settings will be performed immediately, press  icon to return last page .



Picture Playback

Touch  **Memory Playback** icon on main menu, 4 pictures will be displayed in the memo for each page. you can touch  or  to enter last or next picture memo, or touch  icon to delete all pictures. And you can zoom the picture on full screen by touch  icon, on full screen mode, touch   icon to preview last/next picture. or you can touch  icon to delete the picture you are previewing. press  icon to return home screen page.

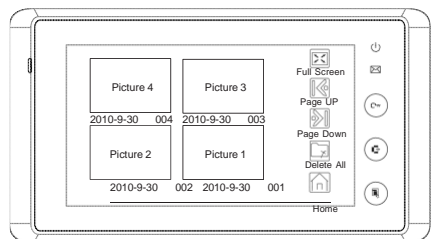





Photo Frame

Photo Playing

Touch  **Album** icon on main menu to play the photos(must plug in SD card).it can be played both manually and automatically,use your fingers to slide right or left on screen to play last/next photo.

Playing time setting

Touch  **Multi Media** icon on main menu to enter next page, then touch  **Album Options** icon,a digital keypad will be showed on the screen,then you can set the playing time by touching the digital keypad to input digitals and press * icon to change the location,and press # icon to save. Settings will be performed immediately, press  icon to return last page .

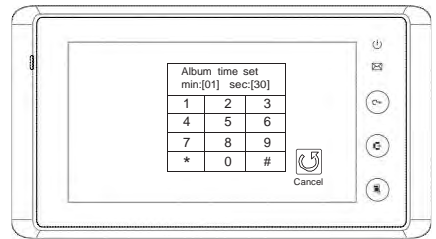

6.Specification

Power Supply :	DC 24V (supplied by Adaptor)
Power Consumption:	Standby 15mA; Working status 400mA
Monitor Screen:	7 Inch color TFT-LCD
Display Resolution:	800*3(RGB)*480 pixels
Built-in Memory:	120 MB
Picture Memo:	800pcs(inner memory),>30000pcs(2G SD card)
Monitor Dimension:	125(H)×225(W)×23(D)mm

Additional Monitor Connections

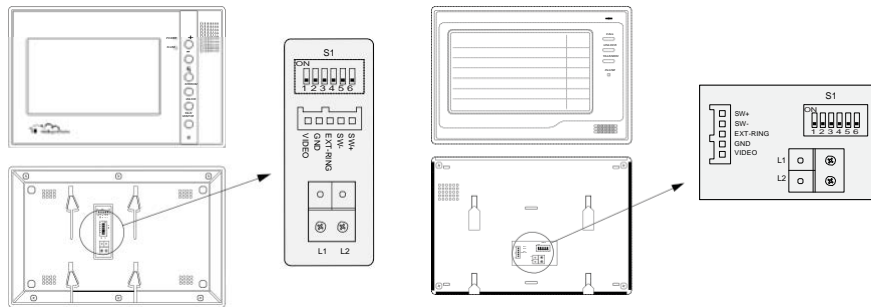

1. Door Bell Call Button

Additional door bell call button can be connected to the Monitor, so that the visitors can ring the door bell again in front of the user's apartment. When the call button is pressed, the Monitor will output ring tones but the screen will keep off, and the external ringer will ring at the same time (if an external ringer is installed).

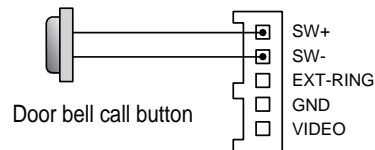

2. External Ringer

External ringer can be connected to the Monitor. The ringer will ring whenever the Door Station call button or the door bell call button is pressed, and it will stop ringing when the Monitor rejects or answers the call.

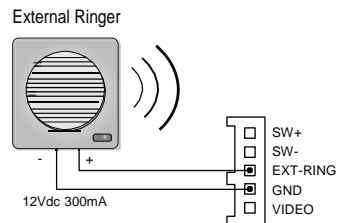

3. TV-out function

Connect television to the Monitor, when the Door Station calls, the user switch the channel to the AV channel, and the visitor's video will show up on the screen of the television. The core of the video cable must connect to the VD terminal, and the shielded layer connect to the GND.

